



## BUTTERFLY VALVE/WAFER TYPE

### GENERAL FEATURES

The closing element in the butterfly valves is a rotating shaft that is placed on a vertical axis. The sealing is provided between the metal flap and the elastic or plastic sealing elements covering the inside of the body. The sealing element also serves as a flange seal between the valve and the pipe.

Advantages of such valves are; low pressure loss, easy opening and closing, good sealing, light weight and small footprint.

The Ayvaz KV-8 Wafer Type Butterfly Valves should be checked to see if they are moving freely during the installation. The valve stem may be horizontal or vertical. However, horizontal installation on DN300 should be preferred.

#### Product Features:

**Body:** GG25 Cast iron

**Disc:** AISI316 Stainless Steel

**Stem:** DN25-DN300=SS420 /  
DN350-DN600=SS431

**Connection:** Lug Type

**Max. Working Temperature:** 130 °C

#### Application Areas:

- Heating, ventilating and air conditioning systems
- Water treatment and distributing systems
- Mining industry
- Shipbuilding and drilling plant
- Food and chemistry industries
- Fire extinguisher systems
- Water, sea water, dust, gas, wastewater and air

#### Notes:

It is recommended to use reducer type for all diameters in butterfly valves. There are only reducer type production on DN350 and above Butterfly valves.

#### Actuator Types

- Hand operated
- Reducer
- Single Action Pneumatic Actuator
- Double Action Pneumatic Actuator
- With Electric Actuator / On-Off (Manual Arm)

| Pressure Class | Diameter (mm) |
|----------------|---------------|
| PN16           | DN (25-300)   |
| PN10           | DN (350-600)  |

| Gasket Material | Min. Temp. (°C) | Max. Temp. (°C) |
|-----------------|-----------------|-----------------|
| H-EPDM          | -10             | 130             |

## KV-8 BUTTERFLY VALVE/LUG TYPE

DN25-DN150

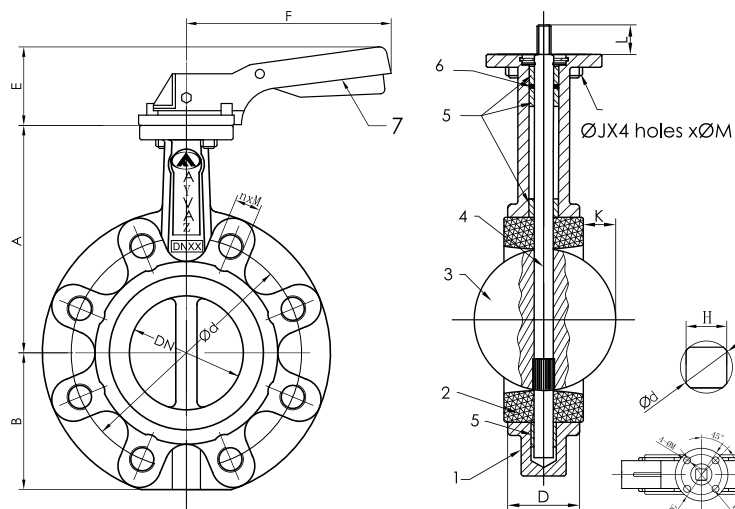

DN200-DN300

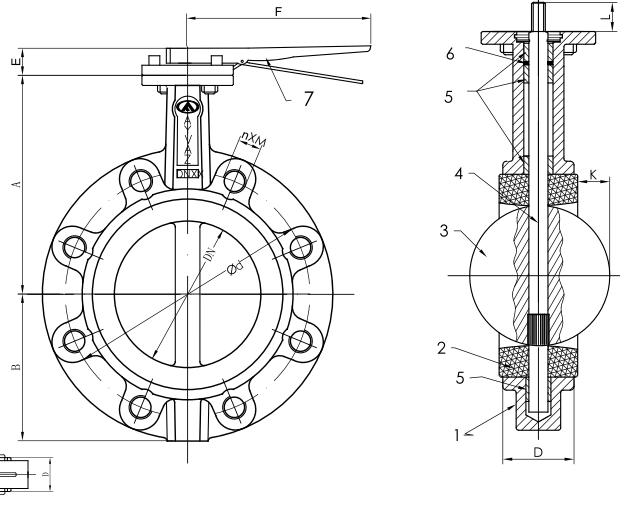

| DN  | A     | B     | K     | D  | E  | F   | H     | ØJ  | ØG  | L <sub>min</sub> | ØM | Ød   | PN16 |        | Weight (kg) |
|-----|-------|-------|-------|----|----|-----|-------|-----|-----|------------------|----|------|------|--------|-------------|
|     | ±2    | ±2    | ±2    | ±1 | ±1 | ±1  | ±0.5  | ±1  | ±1  | ±1               | ±1 | ±0.5 | Ød   | n x d1 |             |
| 25  | 121   | 53    | -     | 33 | 70 | 195 | 7x7   | 50  | 65  | 32               | 7  | 9    | 85   | 4xM12  | 2,4         |
| 32  | 121   | 57    | -     | 33 | 70 | 195 | 7x7   | 50  | 65  | 32               | 7  | 9    | 100  | 4xM16  | 2,5         |
| 40  | 130   | 61    | 2.65  | 33 | 70 | 195 | 9x9   | 50  | 65  | 32               | 7  | 11,8 | 110  | 4xM16  | 3           |
| 50  | 136,5 | 77    | 2.9   | 43 | 70 | 195 | 9x9   | 50  | 65  | 32               | 7  | 11,8 | 125  | 4xM16  | 3,5         |
| 65  | 142   | 87,5  | 6.9   | 46 | 70 | 195 | 9x9   | 50  | 65  | 32               | 7  | 11,8 | 145  | 4xM16  | 4,2         |
| 80  | 158   | 95    | 14.5  | 46 | 70 | 195 | 9x9   | 50  | 65  | 32               | 7  | 11,8 | 160  | 8xM16  | 5,5         |
| 100 | 180   | 107   | 23.7  | 52 | 70 | 195 | 11x11 | 50  | 65  | 32               | 7  | 14,5 | 180  | 8xM16  | 6,7         |
| 125 | 192   | 121,5 | 32.3  | 56 | 71 | 278 | 14x14 | 70  | 90  | 42               | 9  | 18,9 | 210  | 8xM16  | 9,6         |
| 150 | 215   | 144   | 48    | 56 | 71 | 278 | 14x14 | 70  | 90  | 42               | 9  | 18,9 | 240  | 8xM20  | 11,6        |
| 200 | 241,5 | 171   | 68.7  | 60 | 40 | 355 | 17x17 | 102 | 125 | 36               | 11 | 22,5 | 295  | 12xM20 | 18,7        |
| 250 | 280   | 205   | 88.8  | 62 | 44 | 507 | 22x22 | 125 | 150 | 38               | 13 | 29,8 | 355  | 12xM24 | 31,5        |
| 300 | 310   | 235   | 109.8 | 78 | 44 | 507 | 27x27 | 125 | 150 | 38               | 13 | 31,6 | 410  | 12xM24 | 43          |

DN350-DN600

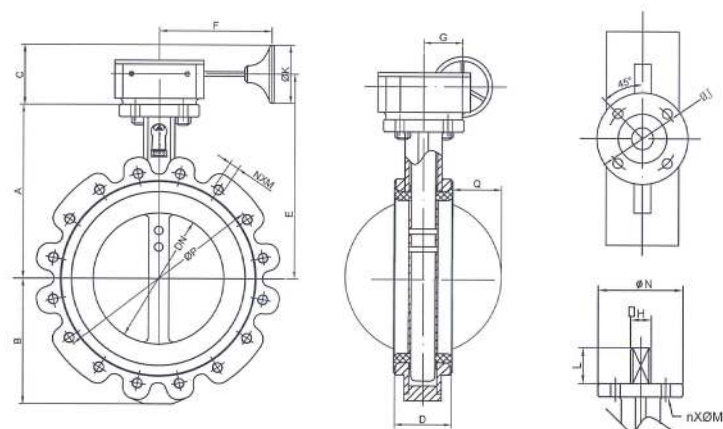

| PRODUCT MATERIAL |        |                          |
|------------------|--------|--------------------------|
| 1                | Body   | EN-GJL-250               |
| 2                | Gasket | EPDM                     |
| 3                | Disc   | AISI 316 Stainless Steel |
| 4                | Shaft  | SS420                    |
| 5                | Ring   | Teflon                   |
| 6                | O-Ring | EPDM                     |
| 7                | Lever  | Aluminum / Forged Iron   |

| DN  | A   | B   | D   | ØJ  | ØN  | ØM | E   | F   | G   | C   | Q     | ØK  | H     | L  | Ød    | PN10 |        | Weight (kg) |
|-----|-----|-----|-----|-----|-----|----|-----|-----|-----|-----|-------|-----|-------|----|-------|------|--------|-------------|
|     |     |     |     |     |     |    |     |     |     |     |       |     |       |    |       | ØP   | NxM    |             |
| 350 | 367 | 266 | 78  | 125 | 150 | 14 | 412 | 223 | 78  | 190 | 127,8 | 300 | 27x27 | 45 | 31,6  | 470  | 16xM24 | 79,25       |
| 400 | 394 | 324 | 102 | 125 | 150 | 14 | 456 | 270 | 120 | 208 | 143,8 | 400 | 27x27 | 50 | 33,2  | 525  | 16xM27 | 122,6       |
| 450 | 419 | 341 | 114 | 165 | 210 | 22 | 481 | 270 | 120 | 258 | 163,3 | 400 | 30x30 | 50 | 37,94 | 585  | 20xM27 | 154,8       |
| 500 | 474 | 374 | 127 | 165 | 210 | 22 | 539 | 339 | 120 | 222 | 182,4 | 300 | 36x36 | 65 | 41,12 | 650  | 20xM30 | 228,25      |
| 600 | 565 | 478 | 154 | 165 | 300 | 22 | 630 | 339 | 120 | 222 | 219,3 | 300 | 46x46 | 70 | 50,62 | 770  | 20xM33 | 308,6       |

## KV-8 BUTTERFLY VALVE/LUG TYPE

### Screw Connection Dimensions

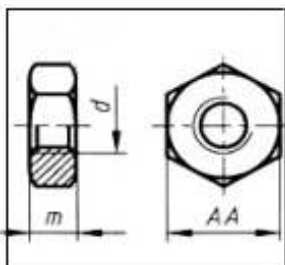

| d (mm) | M10 | M12 | M16 | M20 | M24 |
|--------|-----|-----|-----|-----|-----|
| AA     | 17  | 19  | 24  | 30  | 36  |
| m      | 8   | 10  | 13  | 16  | 19  |

| Dia. | Torque (Nm) |        |
|------|-------------|--------|
| mm   | 10 Bar      | 16 Bar |
| 25   | 9           | 10     |
| 32   | 9           | 10     |
| 40   | 11          | 12     |
| 50   | 15          | 16     |
| 65   | 24          | 26     |
| 80   | 31          | 33     |
| 100  | 48          | 53     |
| 125  | 73          | 81     |
| 150  | 106         | 119    |
| 200  | 177         | 194    |
| 250  | 281         | 308    |
| 300  | 410         | 595    |
| 350  | 475         | 969    |
| 400  | 746         | 1307   |
| 450  | 1112        | 1787   |
| 500  | 1356        | 2288   |
| 600  | 2468        | 3711   |

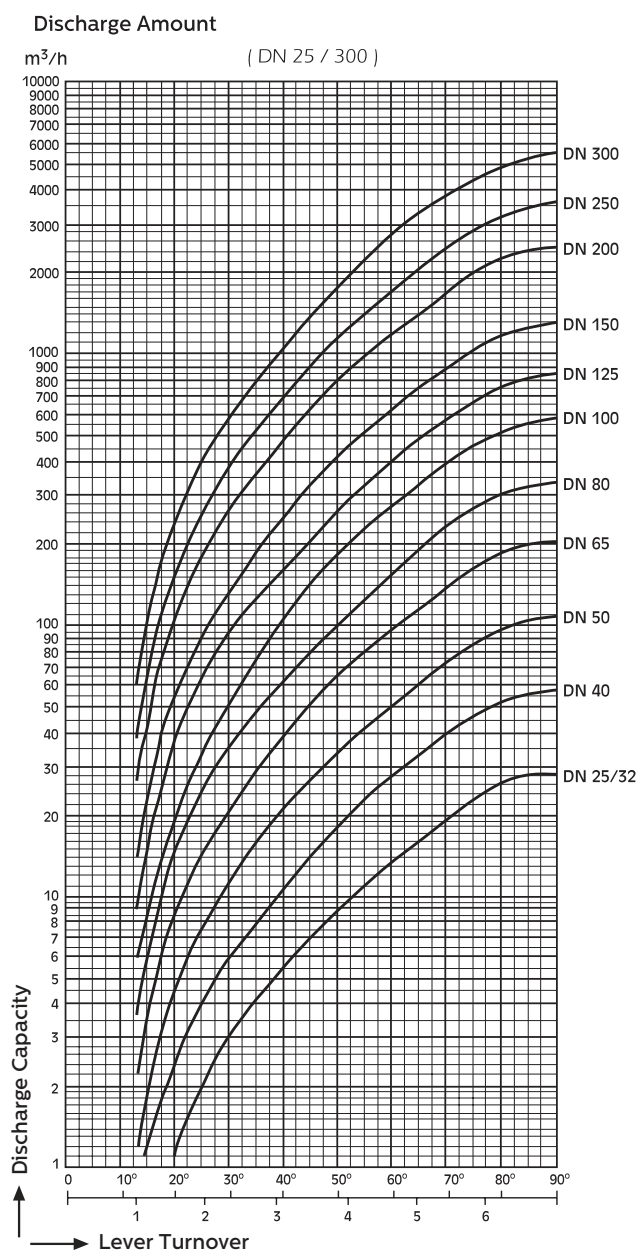

| Pipe Diameter |     | DISC OPENING ANGLE (DEGREE) |     |     |      |      |      |      |      |      |
|---------------|-----|-----------------------------|-----|-----|------|------|------|------|------|------|
| MM            | INC | 10                          | 20  | 30  | 40   | 50   | 60   | 70   | 80   | 90   |
| 40            | 1 ½ | 0,048                       | 2,4 | 5,6 | 12   | 21,6 | 35,2 | 56   | 84   | 92   |
| 50            | 2   | 0,06                        | 3   | 7   | 15   | 27   | 44   | 70   | 105  | 115  |
| 65            | 2 ½ | 0,10                        | 6   | 12  | 25   | 45   | 75   | 119  | 178  | 196  |
| 80            | 3   | 0,20                        | 9   | 18  | 39   | 70   | 116  | 183  | 275  | 302  |
| 100           | 4   | 0,30                        | 17  | 36  | 78   | 139  | 230  | 364  | 546  | 600  |
| 125           | 5   | 0,50                        | 29  | 61  | 133  | 237  | 392  | 620  | 930  | 1022 |
| 150           | 6   | 0,80                        | 45  | 95  | 205  | 366  | 605  | 958  | 1437 | 1579 |
| 200           | 8   | 2                           | 89  | 188 | 408  | 727  | 1202 | 1903 | 2854 | 3136 |
| 250           | 10  | 3                           | 151 | 320 | 694  | 1237 | 2047 | 3240 | 4859 | 5340 |
| 300           | 12  | 4                           | 234 | 495 | 1072 | 1911 | 3162 | 5005 | 7507 | 8250 |