

SINAMICS™

G120P Supplemental System Components

Webserver Module SAM

IOP-2-BT

BOP-2

Blanking Cover



- Webserver Module SAM (Smart Access Module) for access to drives over WiFi using a PC, smartphone, or tablet
- Operator panel IOP-2-BT (Intelligent Operator Panel) with application-specific commissioning wizards, clear text display, and USB interface
- Operator panel BOP-2 (Basic Operator Panel), menu driven and 2-line display
- Blanking cover, degree of protection IP55/UL Type 12
- Drive operating temperature 0...50 °C, with blanking cover 0...60 °C

Anwendung

Operator panels for comfortable on-site commissioning, control as well as diagnostics, and simple cloning of complete VSD data sets. As an option, a blanking cover (IP55) can be used in lieu of the operator panel to cover the interface.

- Webserver module SAM (Smart Access Module)
For fast commissioning, parameterization, and maintenance of G120P drives with WiFi-capable PC, smartphone, or tablet.
- Intelligent Operator Panel IOP-2-BT, degree of protection IP55/UL Type 12
Menu-driven with clear text display, help function and application wizards for commissioning, diagnostics, and operation of standard drives.
- Basic Operator Panel BOP-2, degree of protection IP55/UL Type 12
Menu-driven tool with 2-line display for fast and comfortable commissioning of the VSD. Simultaneous display of parameter and parameter value. Commission a drive without a print out of the parameter list.

Webserver Module SAM

Overview

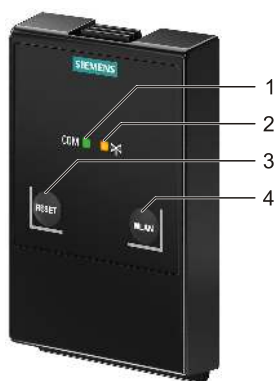

- 1 COM-LED: Shows communication status
- 2 WLAN-LED: Shows WiFi connection status
- 3 Reset button
- 4 WiFi On/Off button

On the rear:

- Type plate
- 1 RS232 plug

Functions

- Wireless operation by using a mobile device or PC.
- Provides users with an integrated webserver for all webpages and data items.
- Integrated description of parameters, diagnostics, and settings in different languages.
- Open for future function extensions, assistants, and languages.
- Degree of protection IP55 provides protection against internal dust deposits and against splash water (from all directions).
- Supports WAP-2 and HTTPS.
- HTML5 user interface provides Interactive view with color information that allow user feel of operating just like apps.

Overview

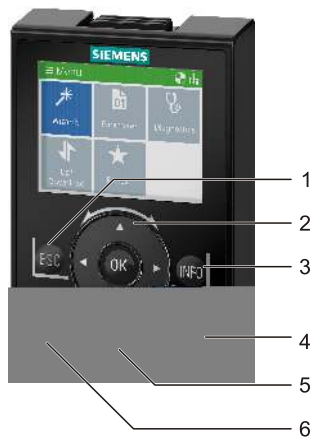

- 1 ESC: Return to menu status or previous display
- 2 Sensor control panel OK button: Select menu items
- 3 INFO: Explanatory help texts
- 4 EIN: Switch on and start the inverter
- 5 HAND/AUTO: Switch from automatic to manual operation
- 6 AUS: Switch off the inverter

On the rear:

- Type plate
- 1 USB port
- 1 RS232 plug
- 4 door-mounting screw recesses

Functions

- Very user-friendly and powerful operator panel for SINAMICS G120P standard drives.
- Easy commissioning, for beginners as well as drive experts thanks to clear text displays, menus, and interactive application wizards.
- Fast commissioning wizard for general commissioning.
- Drive commissioning without printed parameter lists by displaying the parameters in clear text, explanatory help texts, and parameter filters.
- Support of repeat commissioning by loading a parameter list to other drives of the same type (up to 16 parameter sets can be saved).
- Includes wizards for simple configuration of important applications including pumps, fans, and compressors.
- Diagnostics of errors and warning messages displayed in clear text.
- Graphical or numeric visualization of up to two process values.
- Updates and extensions via the integrated USB interface:
 - Drag & Drop to add new drive types, user languages and wizards.
 - Powered via USB interface during updates.
- Pre-installed language packages in German, English, French, Italian, and Spanish.
- Language packages, updates, and extensions are available at no charge under:

<http://support.automation.siemens.com/WW/view/en/30563514/130000>

New in IOP-2-BT

- Fully compatible with the new CU230P-2 firmware V4.7
- More internal memory for extra flexibility (language and firmware updates).
- Reduced loading times of wizards and when searching parameters.
- Enhanced commissioning wizard:
 - Direct selection of motor temperature sensors during commissioning.
 - Better efficiency by entering the motor cos phi.
 - Tunable motor current for even better control and motor protection.
 - Full compatibility with the new HVAC macros for quick application commissioning.

BOP-2

Overview



- 1 ESC: Return to menu status or previous display
- 2 Arrow buttons: Navigate menus and set values
- 3 OK: Select and confirm values
- 4 ON: Switch on and start the inverter
- 5 HAND/AUTO: Switch from automatic to manual operation
- 6 OFF: Switch off the inverter

On the rear:

- Type plate
- 1 RS232 plug
- Door-mounting screw recesses

Funktionen

- Simple commissioning of standard drives with menu-driven 2-line display.
- Drive commissioning without printed parameter lists by displaying the parameters in clear text, explanatory help texts, and parameter filters.
- Direct, menu-driven and easy diagnostics.
- Numeric visualization of up to two process values for simple monitoring.
- Support of repeat commissioning by loading a parameter list to other devices of the same type.

Ordering

Type (ASN)	Order no. / MLFB	Description
G120P-SAM	6SL3255-6AA00-5AA0	SINAMICS G120 Smart Access, Webserver Module (SAM)
G120P-IOP-2-BT	6SL3255-6AA00-4JA2	SINAMICS G120P IP20/IP55, Intelligent Operator Panel (IOP-2-BT)
G120P-BOP-2	6SL3255-6AA00-4CA0	SINAMICS G120P IP20/IP55, Basic Operator Panel (BOP-2)
G120P-BCOVER	6SL3256-6BA00-0AA0	SINAMICS G120P IP20/IP55, Blind Cover (BCOVER)

Accessories

Typ (ASN)	Bestellnummer / MLFB	Beschreibung
G120P-Door-Kit	6SL3256-6AP00-0JA0	SINAMICS G120P Door kit (IP54) / BOP-2 (IP55), KIT UL TYP12 for Intelligent Operator Panel IOP-2 and Basic Operator Panel BOP-2 consisting of: Seals, mounting materials, and connection cable (5 m)

Product documentation

Document	Content	Document ID
Operating Instructions G120 Smart Access	Detailed information on operating the SINAMICS G120 Smart Access	A5E43332549
Operating Instructions IOP-2-BT	Detailed information on operating the SINAMICS IOP-2-BT	A5E39549448B AD
Operating Instructions BOP-2	Detailed information on operating the SINAMICS BOP-2	A5E37143404A AA

System requirements for G120 Smart Access

Device with wireless network adapter	Operating system	Recommended webbrowser
PC	Windows 7	<ul style="list-style-type: none"> Google Chrome 64.0.3239 or higher Internet Explorer 11.0.9600 or higher
	Windows 10	<ul style="list-style-type: none"> Microsoft Edge 38.14393.1066 or higher
Smartphone / Tablet	iOS 10.2 or higher	<ul style="list-style-type: none"> Firefox 10.6 or higher Safari
	Android 6.0.1 or higher	<ul style="list-style-type: none"> Google Chrome 62.0.3202.84 or higher Firefox 58.0.2 or higher

Dimensions

Device	Width	Height	Depth
SINAMICS G120 Smart Access, Webserver-Modul	70 mm	108.5 mm	17.3 mm
SINAMICS G120P IP20 / IP55, Intelligent Operating Panel (IOP-2-BT)		106.9 mm	19.7 mm
SINAMICS G120P IP20 / IP55, Basic Operating Panel (BOP-2)			
SINAMICS G120P Blanking Cover (BCOVER)			