



VORTICEL MPC-C

Ventilatoare axiale de presiune medie cu carcasa

Pentru aplicatii in spatii comerciale si industriale, pentru ventilare generala canalizata in magazine, locale agricole, sere, parcuri subterane etc.

- 10 modele: 5 monofazate si 5 trifazate.
- Carcasa aparatului este compusa din doua flanse (asamblate cu ajutorul a doua suruburi) care permit legarea la conducta.
- Motoare clasa F, monofazate si trifazate, cu elice cu palete profil tip lama.
- Suportul motorului este confectionat din otel, protejat cu vopsea poliesterica de culoare neagra.
- Motoare clasa F.
- Plaja temperaturi de functionare: -25°C / +70°C si -25°C / +50°C pentru modelul 404 M.
- Alimentare electrica: 230V – 50Hz pentru monofazate si 400V – 50Hz pentru trifazate.
- Protectie: IPX4. ⊕
- Clasa izolatie: I

In conformitate cu Regulamentul Nr° 327/2011/UE (Lot 11, primul paragraf) a directive EUP/ErP, in vigoare incepand cu 01.01.2013.

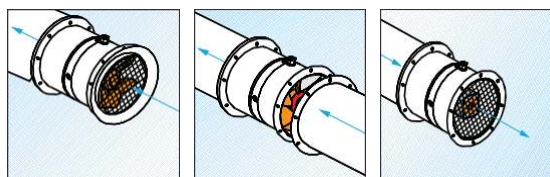

DATE TEHNICE

	Model	Cod	W	A	POLI	RPM	Debit maxim		Presiune maxima		Lp dB(A)*	Lw dB(A)*	Temp. Max °C
							m³/h	l/s	mmH₂O	Pa			
Monofazice	MPC-E 254 M	42263	70	0.32	4	1460	1180	328	9	82	25.3	45.8	70
	MPC-E 302 M	42209	380	1.93	2	2930	2860	794	60.9	597	53.1	73.6	70
	MPC-E 304 M	42210	110	0.5	4	1390	2160	600	10.1	99	34.8	55.3	70
	MPC-E 354 M	42217	200	0.95		1420	3500	972	14.2	139	41.7	62.2	70
	MPC-E 404 M	42228	313	1.5		1417	5000	1389	17	167	49.1	69.6	50
Trifazice	MPC-E 254 T	42359	60	0.21	2	1460	1210	336	8.2	80	25.3	45.8	70
	MPC-E 302 T	42309	397	1.15		2930	2900	805	62	608	53.1	73.6	70
	MPC-E 304 T	42310	107	0.24	4	1400	2250	625	10.4	102	34.8	55.3	70
	MPC-E 354 T	42317	198	0.42		1412	3770	1047	14.2	139	42.5	63	70
	MPC-E 404 T	42328	285	0.52		1345	5200	1444	14.9	146	49.4	69.9	70



Date ErP

Directiva 2009/125/EC de tip ErP (Produse legate de energie)

BEP*											
Model	Cod	Categorie masurare	Categorie eficienta	An constructie	η	N.	(kW) Pe	m ³ /h q	Pa p	RPM	Spec. ratio <1.04
<div> <div>Monofazice</div> <div>Trifazice</div> </div>	MPC-E 302 M	42209	C	01-01-13	27.4	36.4	0.38	2064	180	2916	DA
	MPC-E 354 M	42217			25.7	36.0	0.19	2600	70	1417	
	MPC-E 404 M	42228			29.0	38.5	0.31	3735	87	1414	
	MPC-E 302 T	42309			27.4	36.3	0.40	2097	187	2913	
	MPC-E 354 T	42317			25.2	36.0	0.19	2667	67	1410	
	MPC-E 404 T	42328			27.3	37.1	0.28	3670	75	1337	

*Punctul de eficienta cel mai inalt.

DIMENSIUNI

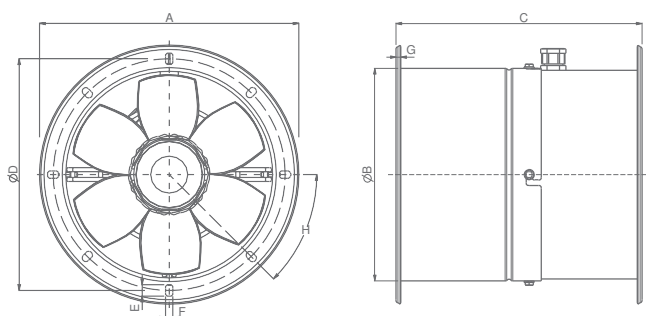

Model	Ø A	Ø B	C	Ø D	E	F	G	H	Kg
MPC-E 254M	319	264	300	292	14	9	4	45l	8.2
MPC-E 254T									8.2
MPC-E 302M	393	316	330	366					12.3
MPC-E 302T				12.3					
MPC-E 304M				10.2					
MPC-E 304T				10.2					
MPC-E 354M	432	368	405	13.4					
MPC-E 354T				13.4					
MPC-E 404M	475	418	448	14					
MPC-E 404T				14					

Dimensiuni (mm)

ACCESORII PRODUS

Model	Cod	Produs
		<div> <div>MPC-E 254 M COD 42263</div> <div>MPC-E 302 M COD 42209</div> <div>MPC-E 304 M COD 42210</div> <div>MPC-E 354 M COD 42217</div> <div>MPC-E 404 M COD 42228</div> <div>MPC-E 254 T COD 42359</div> <div>MPC-E 302 T COD 42309</div> <div>MPC-E 304 T COD 42310</div> <div>MPC-E 354 T COD 42317</div> <div>MPC-E 404 T COD 42328</div> </div>
	IRM 30 Variator de viteza monofazic cu trei pozitii	12921
	IRM 40 Variator de viteza monofazic cu trei pozitii	12922
	IRT 15 Variator de viteza trifazic cu trei pozitii	12923
	IRT 35 Convertizor de frecventa	12924
	IREM 3 Variator de viteza monofazic	12931
	IREM 5 Variator de viteza monofazic*	12932
	IRET 6 Variator de viteza trifazic	12934

* Reglare multiple produse pana la maxim 5 A.

CURBE DE PERFORMANTA

MPC-E 254 M cod 42263

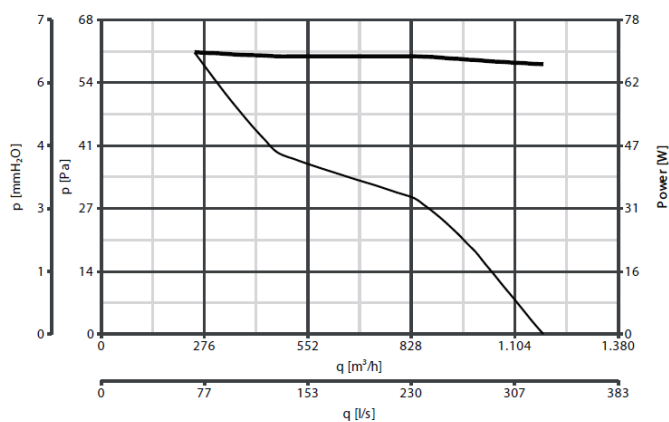

MPC-E 254 T cod 42359

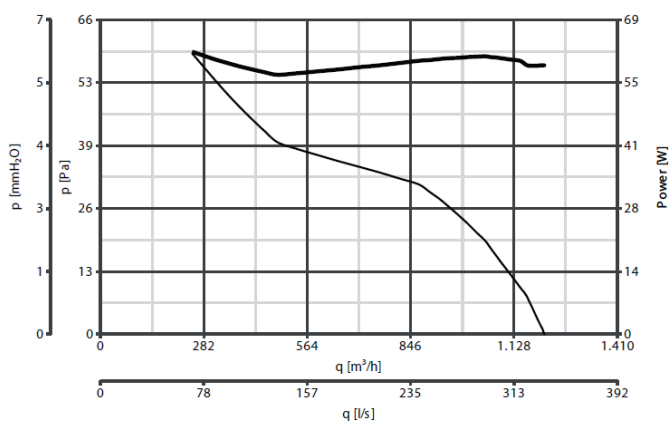

MPC-E 302 M cod 42209

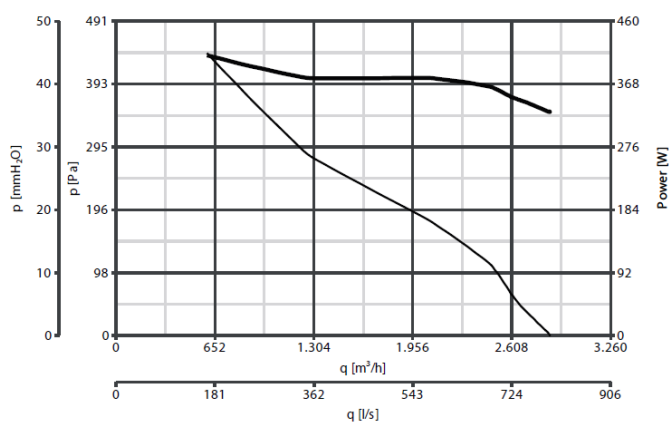

MPC-E 302 T cod 42309

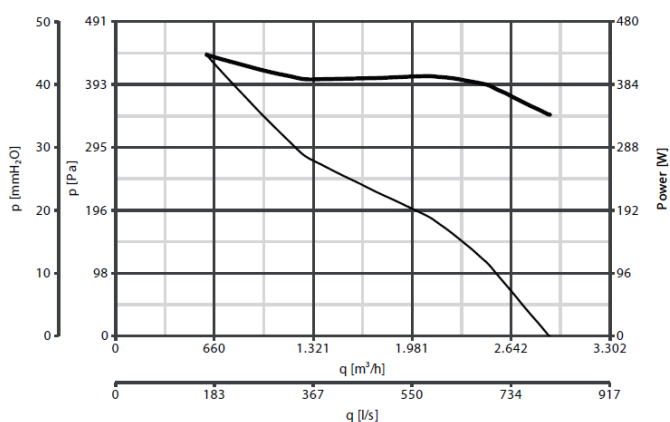

MPC-E 304 M cod 42210

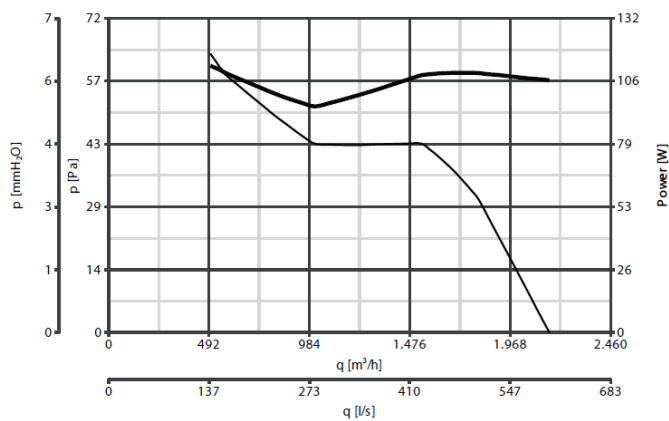

MPC-E 304 T cod 42310

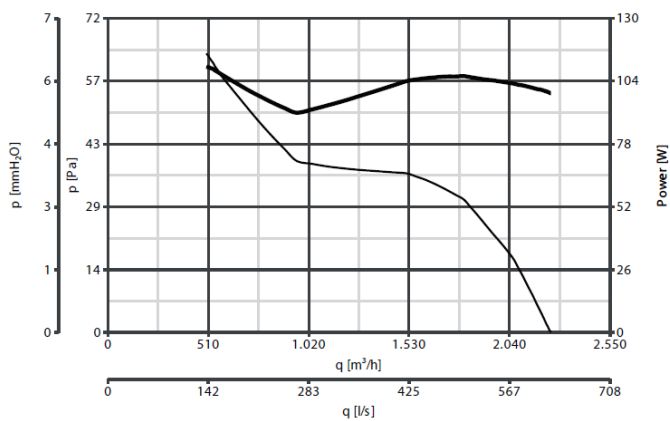

MPC-E 354 M cod. 42217

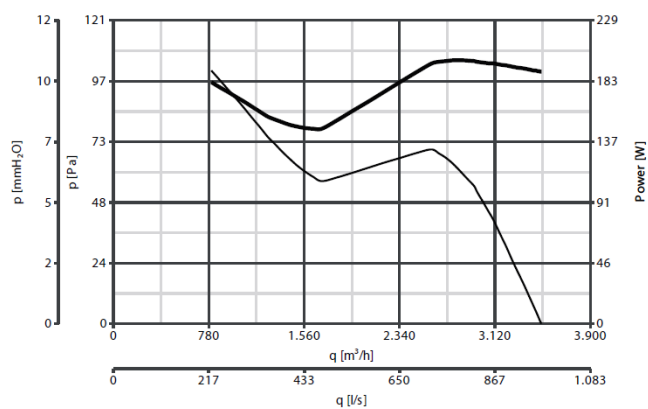

MPC-E 354 T cod. 42317

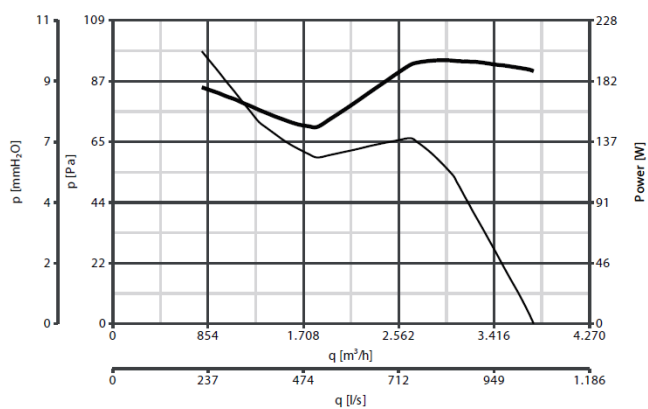

MPC-E 404 M cod. 42228

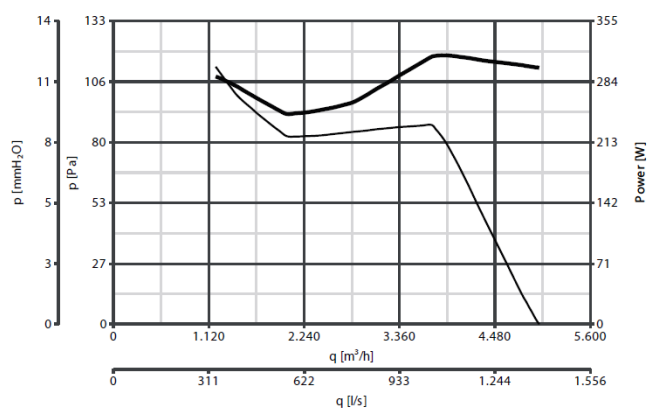

MPC-E 404 T cod. 42328

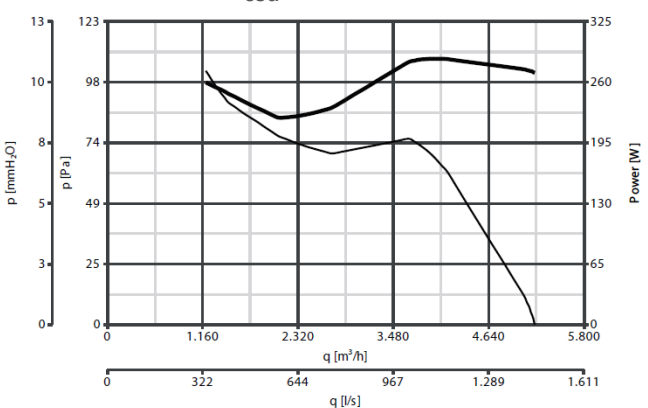

— Livrare — Consum