

TECHNICAL DATA FOR BURNER MATCHING ON BOILERS Mod.:

TRINOx

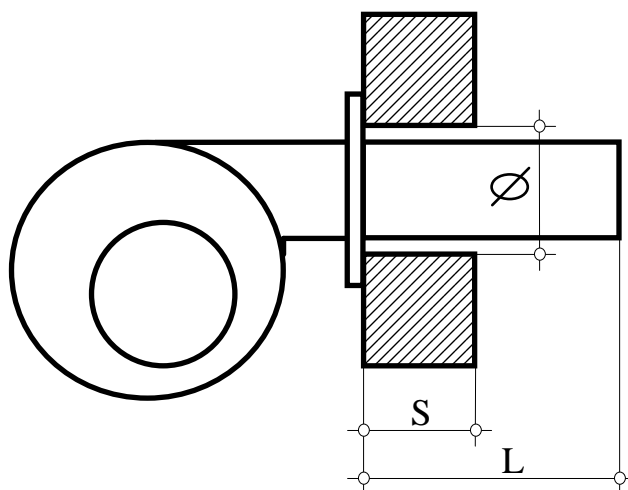

model	Rated Output kW	Furnace Output kW	Furnace pressure mbar	Cement hole on door Ø mm (1)	Thck. Of cement hole S mm	Burner head lenght min/max L mm	type	Furnace internal diameter mm	Furnace internal lenght mm
TRINOx 1000	1165	1260	4,5	270	160	180/280	Passing flame	700	2560
TRINOx 1200	1410	1522	6,6	270	160	180/280		700	2810
TRINOx 1500	1760	1902	5,3	300	190	210/340		804	2835
TRINOx 1750	2040	2210	5,6	300	190	210/340		804	3085
TRINOx 2150	2510	2710	5,6	330	230	250/480		854	3580
TRINOx 2580	3020	3260	5,5	330	230	250/480		920	3580
TRINOx 3000	3520	3810	7,7	330	230	250/480		920	4030
TRINOx 3500	4090	4420	5,4	400	260	280/480		1030	4030
TRINOx 4000	4680	5050	7	400	260	280/480		1030	4480
TRINOx 4300	5030	5450	8,2	400	260	280/480		1030	4480
TRINOx 5000	5830	6310	5,6	500	350	370/550		1076	4850
TRINOx 6000	7020	7590	8,4	500	350	370/550		1076	5350
TRINOx 7500	8760	9460	8,1	550	390	420/600		1206	5650
TRINOx 9000	10560	11400	8,7	550	390	420/600		1306	5950

(1) if burner model is not specified