

KORALUX RONDO COMFORT, RONDO COMFORT - M



Technical Data

Height H	700, 900, 1220, 1500, 1820 mm
Length L	445, 495, 595, 745 mm
Depth B	59, 59, 66, 70 mm
Connecting pitch (KRT)	$h = L - 30 \text{ mm}$
Connecting pitch (KRTM)	50 mm
Connecting thread (KRT)	4 x G 1/2 inside
Connecting thread (KRTM)	6 x G 1/2 inside
Highest allowed working pressure	10 bar
Test pressure	13 bar
Maximum water temperature	110 °C
Flow coefficient (KRT)	$A_T = 2,1 \times 10^{-4} \text{ m}^2$
Flow coefficient (KRTM)	$A_T = 9,3 \times 10^{-5} \text{ m}^2$
Coefficient of resistance (KRT)	$\xi_T = 1,8$
Coefficient of resistance (KRTM)	$\xi_T = 9,3$

Fitting

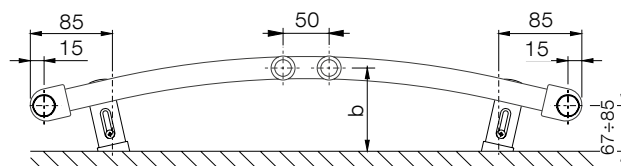

L [mm]	445	495	595	745
b [mm]	96 ÷ 114	96 ÷ 114	103 ÷ 121	104 ÷ 122

The mounting set is delivered as standard and consists of 4 special plastic brackets, screws, dowels and assembly instructions.

Design

KORALUX RONDO COMFORT (KRT) is a towel rail radiator with **bottom connection from the bottom down** with connecting pitch h derived from its length L . The design of the radiator also allows for **double sided connection from the top down**.

KORALUX RONDO COMFORT - M (KRTM) is a towel rail radiator modified for **bottom middle connection** with a connecting pitch of 50 mm.

Steel tubes Ø 24 mm
Steel profile 41 x 35 mm

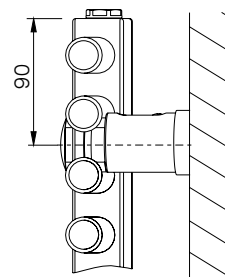

Type of Connection KORALUX RONDO COMFORT

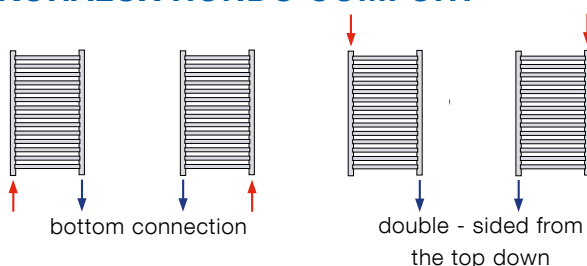

Type of Connection KORALUX RONDO COMFORT - M

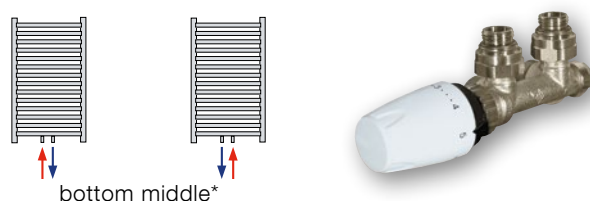

*For radiators with the bottom middle connection you can use the integrated connection fittings HM delivered together with a thermostatic head (see page 39).

The company reserves the right to make technical changes.

KORALUX RONDO COMFORT

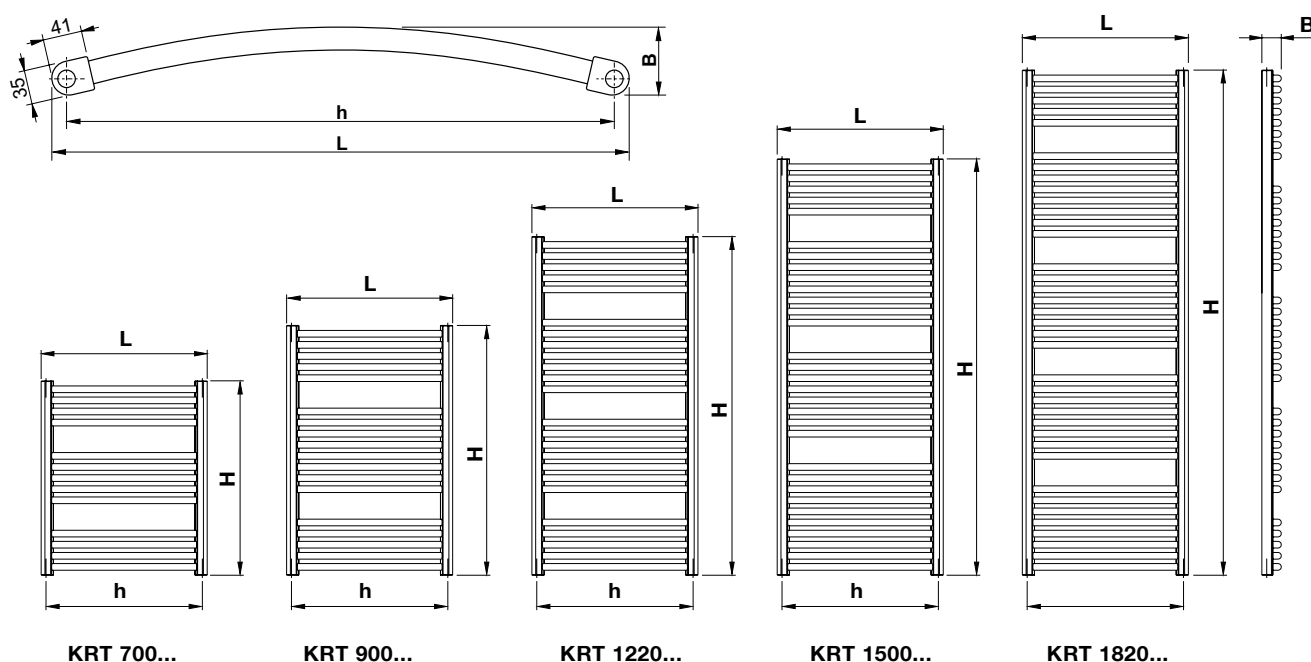

KORALUX RONDO COMFORT - M

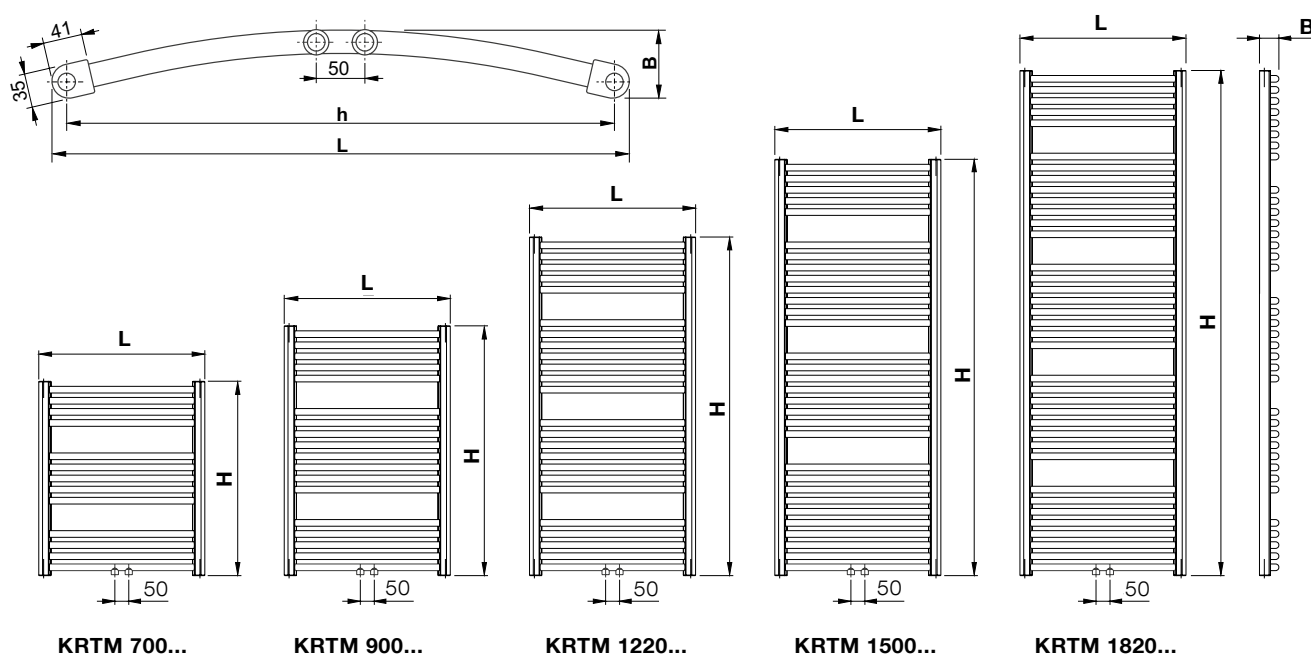

KORALUX RONDO COMFORT - E electric radiators

Model number	Electric input P [W]	M _c [kg]
KRTE 700.500	200	9,3
KRTE 700.600	300	10,4
KRTE 700.750	400	12,2
KRTE 900.450	300	11,5
KRTE 900.500	300	12,3
KRTE 900.600	400	13,9
KRTE 900.750	500	16,4
KRTE 1220.450	400	15,3
KRTE 1220.500	500	16,4
KRTE 1220.600	600	18,6

Model number	Electric input P [W]	M _c [kg]
KRTE 1220.750	700	21,9
KRTE 1500.450	500	19,2
KRTE 1500.500	600	20,6
KRTE 1500.600	700	23,5
KRTE 1500.750	900	27,9
KRTE 1820.450	700	23,0
KRTE 1820.500	800	24,7
KRTE 1820.600	900	28,2
KRTE 1820.750	1000	33,4

M_c = total weight of the radiator including electric heating element and filler

The company reserves the right to make technical changes.

KORALUX LINEAR COMFORT, LINEAR COMFORT - M

KORALUX RONDO COMFORT, RONDO COMFORT - M

HEAT OUTPUT Q [W] FOR WATER
AS A HEAT-CARRYING AGENT CERTIFIED TO EN 442

BASIC TECHNICAL PARAMETERS

Model number	H [mm]	L [mm]	h [mm]	t ₁ /t ₂ [°C]	Q [W] for t _f [°C]					Nominal heat output Q [W] (75/65/20°C)	Temperature exponent n [-]	Radiator weight M _r [kg]	Water volume V _r [l]	Max. heat output E - element P [W]*
					15	18	20	22	24					
KLT (KLTM) 700.450 KRT (KRTM) 700.450	700	450 445	420 (50) 415 (50)	75/65	323	301	287	273	259	287	1,2452	5,0	3,4	200
				70/55	269	248	234	221	207					
				55/45	184	165	152	139	127					
KLT (KLTM) 700.500 KRT (KRTM) 700.500	700	500 495	470 (50) 465 (50)	75/65	355	331	315	299	284	315	1,2421	5,3	3,6	200
				70/55	296	273	257	242	228					
				55/45	202	181	167	153	140					
KLT (KLTM) 700.600 KRT (KRTM) 700.600	700	600 595	570 (50) 565 (50)	75/65	416	388	370	352	334	370	1,2358	6,1	4,1	300
				70/55	347	320	303	285	268					
				55/45	238	213	197	181	165					
KLT (KLTM) 700.750 KRT (KRTM) 700.750	700	750 745	720 (50) 715 (50)	75/65	506	472	450	428	406	450	1,2263	7,2	4,8	400
				70/55	423	390	369	348	327					
				55/45	291	260	241	221	202					
KLT (KLTM) 900.450 KRT (KRTM) 900.450	900	450 445	420 (50) 415 (50)	75/65	416	388	369	351	333	369	1,2489	6,6	4,5	300
				70/55	346	319	301	284	266					
				55/45	236	211	195	179	163					
KLT (KLTM) 900.500 KRT (KRTM) 900.500	900	500 495	470 (50) 465 (50)	75/65	456	425	405	385	365	405	1,2463	7,1	4,8	300
				70/55	380	350	331	311	292					
				55/45	260	232	214	197	179					
KLT (KLTM) 900.600 KRT (KRTM) 900.600	900	600 595	570 (50) 565 (50)	75/65	535	499	475	452	428	475	1,2412	8,2	5,5	400
				70/55	446	411	388	366	343					
				55/45	305	273	252	231	211					
KLT (KLTM) 900.750 KRT (KRTM) 900.750	900	750 745	720 (50) 715 (50)	75/65	651	608	579	551	522	579	1,2334	9,7	6,6	500
				70/55	544	501	474	446	419					
				55/45	373	334	308	283	258					
KLT (KLTM) 1220.450 KRT (KRTM) 1220.450	1220	450 445	420 (50) 415 (50)	75/65	568	529	504	479	454	504	1,2549	8,8	6,1	400
				70/55	473	435	411	387	363					
				55/45	322	288	265	243	222					
KLT (KLTM) 1220.500 KRT (KRTM) 1220.500	1220	500 495	470 (50) 465 (50)	75/65	623	581	553	525	498	553	1,2532	9,5	6,5	500
				70/55	519	478	451	425	399					
				55/45	354	316	292	267	244					
KLT (KLTM) 1220.600 KRT (KRTM) 1220.600	1220	600 595	570 (50) 565 (50)	75/65	732	683	650	618	586	650	1,2499	10,9	7,4	600
				70/55	610	562	531	499	469					
				55/45	416	372	343	315	287					
KLT (KLTM) 1220.750 KRT (KRTM) 1220.750	1220	750 745	720 (50) 715 (50)	75/65	891	831	791	752	713	791	1,2448	13,0	8,8	700
				70/55	742	684	646	608	571					
				55/45	507	454	419	384	350					
KLT (KLTM) 1500.450 KRT (KRTM) 1500.450	1500	450 445	420 (50) 415 (50)	75/65	706	658	626	595	564	626	1,2589	11,2	7,7	500
				70/55	587	541	510	480	450					
				55/45	400	357	329	302	275					
KLT (KLTM) 1500.500 KRT (KRTM) 1500.500	1500	500 495	470 (50) 465 (50)	75/65	774	722	687	653	619	687	1,2573	12,1	8,2	600
				70/55	644	593	560	527	495					
				55/45	439	392	361	331	302					
KLT (KLTM) 1500.600 KRT (KRTM) 1500.600	1500	600 595	570 (50) 565 (50)	75/65	911	849	808	768	728	808	1,2543	13,8	9,4	700
				70/55	758	698	659	620	582					
				55/45	517	462	426	390	356					
KLT (KLTM) 1500.750 KRT (KRTM) 1500.750	1500	750 745	720 (50) 715 (50)	75/65	1108	1033	984	935	887	984	1,2497	16,5	11,2	900
				70/55	923	851	803	756	710					
				55/45	630	563	520	477	435					
KLT (KLTM) 1820.450 KRT (KRTM) 1820.450	1820	450 445	420 (50) 415 (50)	75/65	871	811	772	733	695	772	1,2634	13,4	9,2	700
				70/55	724	666	629	592	555					
				55/45	492	439	405	371	338					
KLT (KLTM) 1820.500 KRT (KRTM) 1820.500	1820	500 495	470 (50) 465 (50)	75/65	956	891	848	805	763	848	1,2621	14,5	9,9	800
				70/55	795	732	691	650	610					
				55/45	541	483	445	408	372					
KLT (KLTM) 1820.600 KRT (KRTM) 1820.600	1820	600 595	570 (50) 565 (50)	75/65	1123	1046	996	946	897	996	1,2594	16,6	11,3	900
				70/55	934	860	812	764	717					
				55/45	636	568	523	480	437					
KLT (KLTM) 1820.750 KRT (KRTM) 1820.750	1820	750 745	720 (50) 715 (50)	75/65	1367	1274	1213	1152	1092	1213	1,2553	19,8	13,4	1000
				70/55	1137	1048	989	931	874					
				55/45	775	693	639	586	534					

* Stated maximum output values of the electric heating element apply for combined heating (see page 38)

Characteristic equation: $\Phi = K_T \cdot L^a \cdot H^b \cdot \Delta T^{(c_0+c_1 \cdot H)}$	K _T	a	b	c ₀	c ₁
	2,26531 x 10 ⁻⁵	0,8842066	0,9284211	1,2280052	2,37639 x 10 ⁻⁵

The heat output stated are valid for bottom connection and central bottom connection.